

ENJOY BENALLA

CERAMIC MURAL



EXPLORE AND DISCOVER

Explore the nooks and crannies of Benalla's Ceramic Mural, and be rewarded as this curving, complex structure slowly reveals itself to the delight of children and adults alike.

Contributors to this open-air gallery include nationally significant artists, 1500 regional students and countless volunteers.

The mural, which became part of the collection of the Benalla Art Gallery in 2005, integrates the skills of traditional potters, the vision of indigenous people and the passion of guided amateurs, young and old.

THE MURAL IN THE MAKING

The Ceramic Mural project was initiated by local community organisations and local, state and federal governments, and was funded by the Australia Council.

It commenced as a community art project in 1983, using the skills of ceramic artists, architects, and the wider community.

Judy Lorraine, appointed as Artist in Residence in 1985, created the model and architectural drawing, and the project took 25 years to complete.

It was officially opened in 2010 by the Mayor Cr Bill Hill.

Benalla Art Gallery, Bridge Street, Benalla, VIC 3672
Tel: **03 5760 2619** www.benallaartgallery.com

Benalla Visitor Information Centre
Mair Street, Benalla, VIC 3672, 9am - 5pm daily
Tel: **03 5762 1749** www.enjoybenalla.com.au

**CREATIVE
VICTORIA**



**BENALLA
ART GALLERY**



BENALLA

RURAL CITY



THE UPPER TERRACE

Offering a view across Lake Benalla, this section highlights handmade ceramic paving and wall tiles. Visiting and local ceramic artists produced designs within the wave form tile.

THE AMPHITHEATRE

This small circular performance area is paved with hand made hexagonal tiles and is surrounded by tiered bull-nose bricks. It seats around 100 people.

THE FRIEZE WALL

This major section was developed between 1985 and 1986. Victorian TAFE Institutes created the sculptural wall and the ceramics were manufactured and fired at the Benalla Airport Huts workshop.

TURQUOISE DOMES

The turquoise glazed ceramic domes mark the ideal spot for a 360 degree view. The domes are also access points to one of two thongaphones, a series of sculpted pipes tuned to a pentatonic scale and played with a thong.



The round seat at the mural entrance is capped with a glazed ceramic spire. The twin domes and the historic Benalla Monash Bridge can be seen in the background.

Nestled in the landscape, the mural emerges from the rolling green lawns. Providing a contrast of colour, the open space is an important element in the design.

PLAN VIEW

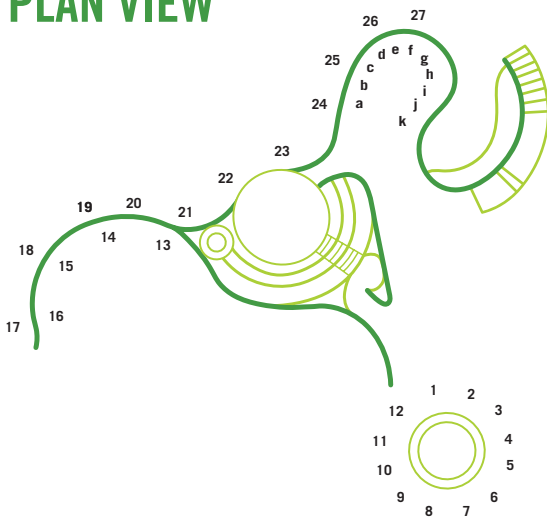

CHILDREN'S PAVING TILES

- | | | | |
|----|-----------------|----|-----------------|
| 1 | St. Josephs PS | 13 | St. Josephs PS |
| 2 | Benalla West PS | 14 | Benalla West PS |
| 3 | Broken Creek PS | 15 | Benalla East PS |
| 4 | Devenish PS | 16 | Thoona PS |
| 5 | Goorambat PS | 17 | Benalla 31 PS |
| 6 | Thoona PS | 18 | Benalla West PS |
| 7 | Glenrowan PS | 19 | Devenish PS |
| 8 | Benalla East PS | 20 | St. Josephs PS |
| 9 | Tatong PS | 21 | Benalla East PS |
| 10 | Swanpool PS | 22 | Baddaginnie PS |
| 11 | Warrenbayne PS | 23 | Tatong PS |
| 12 | Benalla 31 PS | 24 | Benalla 31 PS |
| | | 25 | Benalla West PS |
| | | 26 | Benalla East PS |
| | | 27 | St. Josephs PS |

CAVE SEAT ARTISTS

- | | |
|---|-------------------------------------|
| a | Petrus Spronk |
| b | Fiona Murphy |
| c | Judy Lorraine and David Moore |
| d | Sue Moorhead |
| e | Ian Sprague |
| f | Thancoupie |
| g | Chris Thorne |
| h | Judy Lorraine |
| i | Broken River Potters Michael Leunig |
| j | Broken River Potters Sam Jinks |
| k | Ann Ferguson |

CREDITS

Australia Council
Bicentennial Authority
Commonwealth Employment Program
Arts Victoria
Department of Education
Benalla Rural City Council
Benalla Art Gallery

David N Moore and David W Moore
The J & J Merrigan Trust
Sidney Myer Foundation
The Fairley Foundation
Benalla Forum (now The Centre)
Mural Committee Members 1983-2010
Benalla Rotary, Lions, and Apex Clubs

Broken River Potters
Local and Interstate Potters
Friends of the Benalla Art Gallery
Benalla Lakeside Craft & Farmers Market Inc
Private Sponsors and Anonymous Donors
Volunteers

Photography by Stephan Mielch