

Our Museum



Our Museum

The Old Butter Factory Precinct is nestled on the banks of the picturesque Vasse River. A replica of the former Jetty Rotunda enhances the vista and the exhibits demonstrate Busselton's diverse agricultural, forestry and maritime history.

Special attention is focused on the famous 1920's Group Settlement Scheme which shaped much of the development of the South West.

Special Features

- The Heritage Butter Factory building has ten display rooms packed with photographs, equipment and memorabilia which trace the family, social, civic, commercial and maritime history of Busselton
- A fully restored and furnished Group Settlement House
- A fully restored and furnished 1920's one-teacher school
- The "Jumna" Paddle Steamer built by Canon Davies
- Horse drawn vehicles and machinery
- Timber industry artefacts
- General farming engines and memorabilia
- Restored butter making equipment and machinery



Your Visit

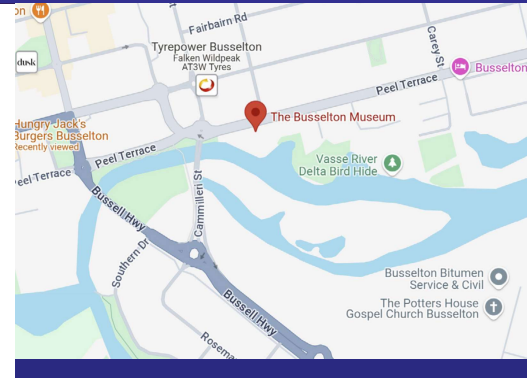

Where are we

The Old Butter Factory Precinct,
76 Peel Terrace, Busselton

Visiting Times

10am to 4pm (Admission fees apply)
Wednesday to Monday

Closed Good Friday and Christmas Day

Make bookings for Group and School tours
from website

Contact Us

General enquiries
secretary@busseltonhistoricalsociety.org.au

Research enquiries
research@busseltonhistoricalsociety.org.au

Phone (08) 9754 2166

Website www.busseltonmuseum.org.au

f busseltonmuseum.org.au



Explore Busselton's Heritage

Includes Museum Map showing
wheelchair accessible areas

Old Butter Factory Layout

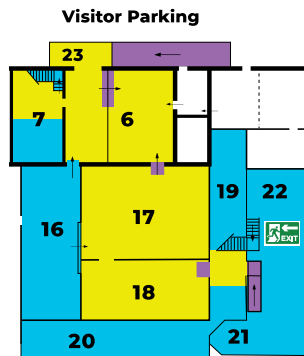

Ground Floor (Internal exhibits)

- 6. Reception & Early Settlers Room
- 7. Marine Room
- 16. Timber Room
- 17. Early Settlers & Life Styles
- 18. Dairy Room

Ground Floor (External exhibits)

- 19. Loading Dock / Laundry
- 20. Butter Making
- 21. Cream Can Steriliser
- 22. Open Exhibition Area
- 23. Museum Entry

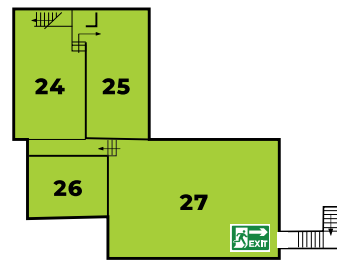

Upper Floor (Access via stairs only)

- 24. Homelife
- 25. Bedroom & Nursery
- 26. Kitchen
- 27. General Exhibits

- Wheelchair Accessibility
- Ramps
- No Public Access

Precinct Site Plan

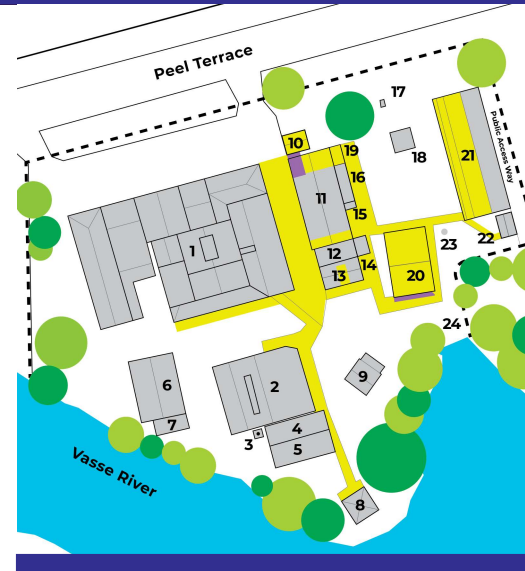

Site Attractions

- 1. Main Factory Building comprising the original 1918 butter factory and later extensions
- 2. Boiler House and Harness Room
- 3. Smoke Stack
- 4. Storage Container (no public access)
- 5. Storage Shed (no public access)

- 6. Museum Workshop used by BHS for restoration and repair work (no public access)
- 7. Museum Shed (no public access)
- 8. Replica of former Busselton Jetty Rotunda
- 9. Teacher's Residence, former Jindong State School
- 10. Ambergate Telephone Exchange
- 11. Machinery Display Shed including Jumna Display
- 12. Group Settlement Humpy
- 13. Toilets
- 14. Fishing Display
- 15. Pan Toilet
- 16. Shearing and Milking Display
- 17. Horse Mill
- 18. Group Settlement Milking Shed
- 19. Group Settlement Dairy
- 20. Group Settlement House
- 21. Carriage Display Shed
- 22. Busselton Aerodrome WW2 Medical Hut
- 23. Hand Water Pump
- 24. Vasse Floodgates