

1. Bynya Homestead

Original Bynya Station Homestead built in 1879, occupied until 1970.

2. Italian Museum and Cultural Centre

Opened in 2004, display covers immigration, improvisation and tradition consolidation.

3. Wumbulgal School

Typical Australian one teacher school. Built at Euroly in 1909 moved to Wumbulgal in 1932.

4. Public Toilets

5. Myall Park Hall

Built in 1936 as the Community hall at Myall Park. The hall is now used for functions and is available for hire.

6. Wine and Irrigation building

This exhibition interprets the development of irrigation and the local wine industry.

Todd Shed

A unique collection of carts and vintage Rugby vehicles, revamped and repaired by Ian Todd.

7. Aboriginal Scar trees

A canoe has been carved off the tree that was alive and the tree regenerates and leaves the 'scar'. The multi scar tree holds the markings of carriers for Gudha (babies) or utensils and food.

8. M.I.A. Fibro House

An example of early a settler's house. These homes were subsidised by the Irrigation Commission. Originally located at Benerembah, it was built in 1938 and lived in until 1970s.

9. Shearing Shed

Alf Baker, an early museum volunteer, built this shed on his property at Merriwagga in 1932. It is complete with shearing stands, wool table and wool press. Alf re-located the shed to the Museum in 1982.

10 - 13. Rathbone Selection

A cottage, cellar, stables and blacksmiths relocated in 1975. Originally built in Victoria in 1872 and brought here by Mr Roy Rathbone, a founding Museum member.

14. Griffith Hospital

Griffith's first hospital built in 1922 and situated in Banna Ave. Closed in 1933 when the new Base Hospital was built.

15. Goolgowi Railway Station

Built in 1923, primarily for transporting wheat, wool and livestock to the market place.

16. Area News Building

Houses printing machines and equipment. The Area News' began in 1923 and is still Griffith's local newspaper.

17. The OKAY Fruit Stall

Built in 1954, operated in Griffith's main street until 1967.

18. Taylor Bros. Store

Recreation of Griffith's first retail store, operated in the main street from 1919 to 1941.

19. Saddlery

A drop-log saddler's shop, displaying harnesses and saddlers equipment.

20. Fire Engine Shed

Housing NSW Fire No.8.1 commissioned by the NSW Fire Brigade in 1927. The engine serviced Grafton, Singleton and the South Coast region until 1961 when it was purchased and brought to the area.

21. The Knitted Garden

A portable school room formerly used at Griffith High, currently housing the Knitted Garden.

▣ Baptist Church

Built in 1925 and was relocated in 1973 - currently under repair.

22. Soldier Settler's hut

Built in 1919 on Farm 1480, Yenda, using timber felled from the farm when clearing

the land. Used as a residence until 1934, then as workers accommodation.

23. Dumossa Inn

Re-creation of Dumossa Inn with dismantled logs from Gunbar farms and Dumossa Homestead.

24. Groongal Coach House

The original coach house from Groongal Station near Hay, built between 1868-1875.

25. Blacksmith & Wheelwright

These shops are in use on open days.

26. Gunbar Lockup

Transportable gaol. Built at Gunbar in 1906 and moved to Merriwagga in 1928.

27. Bagtown Re-creation

A recreation of the makeshift commercial and residential sections of 'old Griffith' known as Bagtown. It was the home to many Irrigation Area Pioneers between 1912 and 1922.

28. St. James Church

Built originally in 1907 near Bilbul. Moved by a bullock drawn sled to the village of Hanwood in 1913, used for Anglican worship until 1971.

29. Bagtown Gaol

1914 portable gaol originally located in Bagtown. Moved in 1922 to the Griffith police station in Benerembah Street.

30. Irrigation Shed

Display of equipment including cotton harvester, orange grader, and Griffith's first transportable carrot washer.

31. Stationary Engine Shed

A display of engines, ranging from small portable types to larger engines including a Davey Paxman 4cylinder, 106HP marine engine.

32. Kooba Generator

Used on Kooba property prior to WWI until 1951. The generator transferred

power to pumps which pumped water for irrigation. (Griffith Lions Club project)

33. Clearing the Land Shed

Equipment used in clearing land, including a log jinker and a mallee roller, both man made from timber.

34. Steam Shed

Houses a steam boiler which provides power to several smaller steam powered equipment.

35. Machinery Shed

Early tractors, harvesters, reapers and binders, chaff makers and other farming machinery.

36. Sharam Hall

Built 2005, this storage facility houses the museum's objects and textile collection.

37. Griffin Building

A demountable office building brought to Farm 223 Yoogali, in 1921 as accommodation for the Griffin sisters.

38. Fairview Cottage

A drop log cottage built in 1880 by Alfred Hill and family at Tabbita (Goolgowi district). Extensions were done and breezeway closed in to accommodate the growing family. It was lived in until 1953 when the youngest son passed away. It was named Fairview by Mr Hill as he stated he could see a "Fair view of work for the rest of my life".

39. Post O ice

Griffith's first major Post Office, operated from 1917-1969. Volunteers rebuilt on site using all the original internal fittings, windows etc.

40. Temporary Display Building

Accommodates changing displays of the Museum's textile collection.

griffith

Pioneer Park Museum

www.griffithpioneerpark.com.au

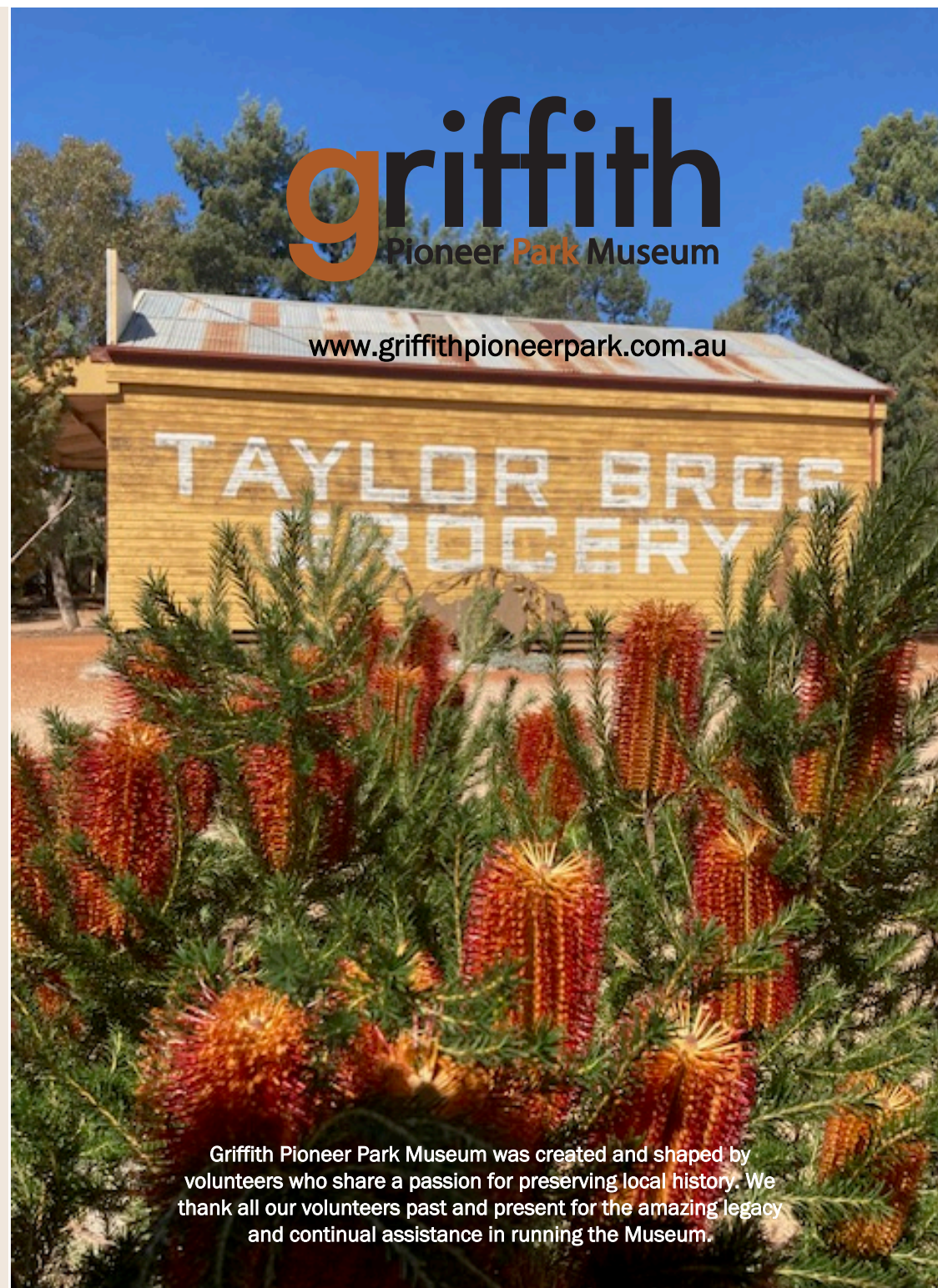

Griffith Pioneer Park Museum was created and shaped by volunteers who share a passion for preserving local history. We thank all our volunteers past and present for the amazing legacy and continual assistance in running the Museum.



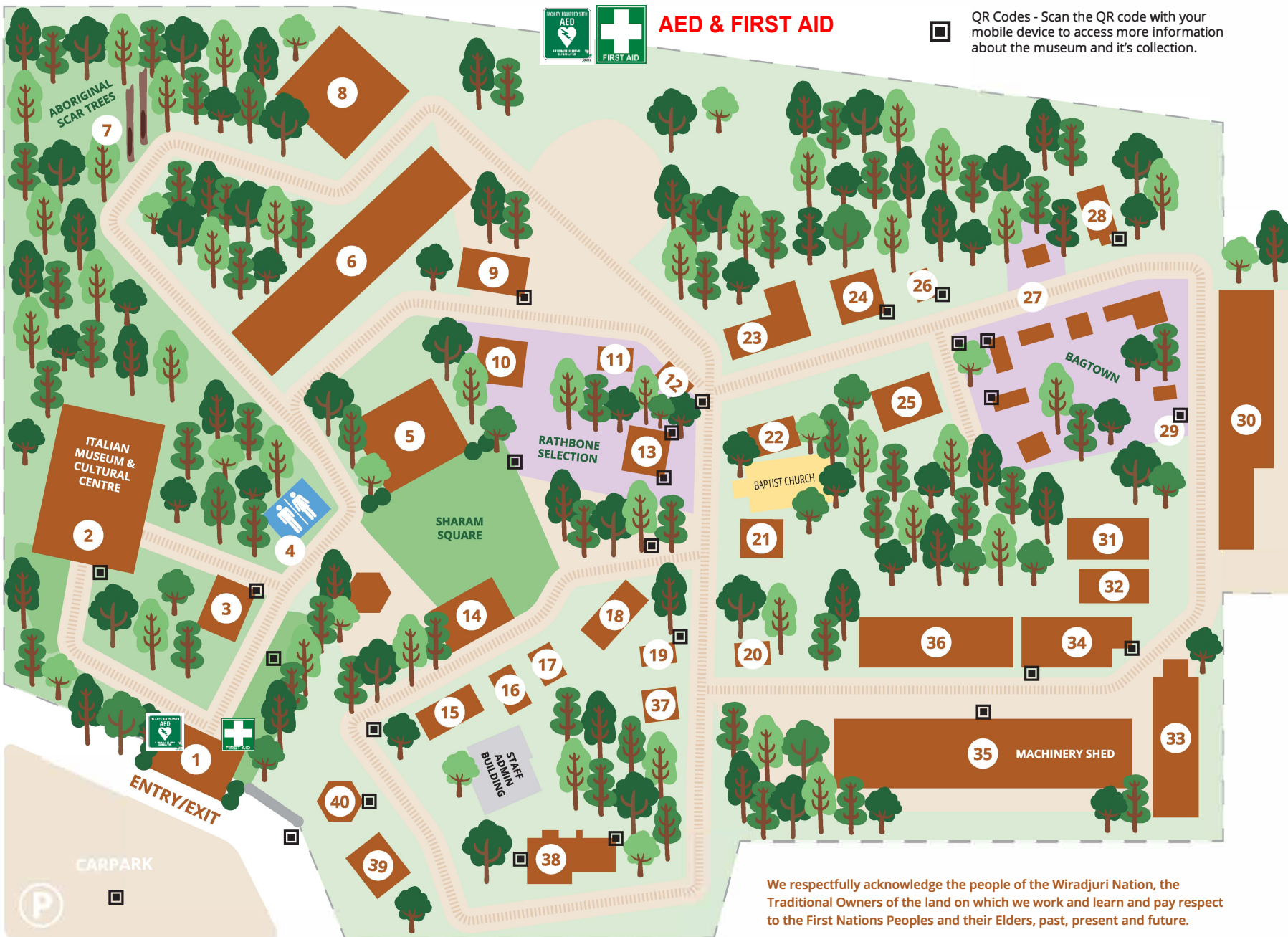

AED & FIRST AID

QR Codes - Scan the QR code with your mobile device to access more information about the museum and its collection.

DID YOU KNOW?

The Museum site was originally a stone quarry. Volunteers commenced work on the Museum in 1969.

ACTION DAY

Our first major fundraising event coincided with the official opening of the Museum during Easter 1971. The volunteers thought that they would welcome 50 people but over 1,000 attended

DID YOU KNOW?

One of the striking features of Griffith is its Italian cultural influence. Some 60% of the population is of Italian heritage.

KEEP THE MUSEUM SAFE

To assist us in conserving our exhibits and to ensure your safety whilst visiting the museum we ask that you please:
 Do NOT climb on the machinery.
 Do NOT go beyond barriers.
 Close the doors of the buildings when you leave.

We respectfully acknowledge the people of the Wiradjuri Nation, the Traditional Owners of the land on which we work and learn and pay respect to the First Nations Peoples and their Elders, past, present and future.

- | | | | | | | |
|---------------------------------------|---|------------------------------|---------------------------|------------------------------|----------------------------|--------------------------------|
| 1. Bynya Homestead | 6. Wine and Irrigation building and Todd Shed | 14. Griffith Hospital | 20. Fire Engine Shed | 25. Blacksmith & Wheelwright | 31. Stationary Engine Shed | 37. Griffin Building |
| 2. Italian Museum and Cultural Centre | 7. Aboriginal Scar Trees | 15. Goolgowi Railway Station | 21. The Knitted Garden | 26. Gunbar Lockup | 32. Kooba Generator | 38. Fairview Cottage |
| 3. Wumbulgal School | 8. M.I.A. Fibro House | 16. Area News Building | 22. Soldier Settler's hut | 27. Bagtown Re-creation | 33. Clearing the Land Shed | 39. Post Office |
| 4. Public Toilets | 9. Shearing Shed | 17. The OKAY Fruit Stall | 23. Dumossa Inn | 28. St. James Church | 34. Steam Shed | 40. Temporary Display Building |
| 5. Myall Park Hall | 10 - 13. Rathbone Selection | 18. Taylor Bros. Store | 24. Groongal Coach House | 29. Bagtown Gaol | 35. Machinery Shed | |
| | | 19. Saddlery | | 30. Irrigation Shed | 36. Sharam Hall | |