

Suitable sites for Wedding Parties. Book online or contact bookings@rhodogarden.org.au



*** Points of Interest**

1. Dick Harris Lookout
2. Centenary Walk
3. McCulloch Bridge
4. The Lake
5. First Official Function - Lake Opening
6. Dr Nick Matheson-Lines Lookout
7. Dr A. L. North Conifer Garden
8. Protea Garden

- A. Cherry Tree Valley
- B. Pryor Bridge
- C. Weeping Elm Glade
- D. Oreades
- E. McCulloch Bridge (photos only)
- F. The Glen

LEGEND
 Paved paths
 Unpaved paths
 Steps

| Rhodo Garden Tracks (Metres) | | |
|------------------------------|--------|------------------------|
| Trk | Length | Name |
| A | 130 | Bob Baker Walk (Upper) |
| B | 100 | Bob Baker Walk (Lower) |
| C | 155 | Centenary Walk |
| D | 100 | Zig Zag Walk |
| E | 90 | Soroptomists Walk |
| F | 230 | Maple Crescent |
| G | 270 | Glade Walk |
| H | 145 | Volunteers' Way |
| J | 200 | Lake Walk |
| K | 55 | Upper Quota Grove |
| L | 100 | Quota Grove |
| M | 260 | Fox Cave Nature Trail |
| N | 100 | To Conifer Garden |
| P | 750 | Fire Trail |
| Q | 390 | Old Lookouts Track |
| R | 280 | Nature Trail Loop |
| S | 85 | West Rhodo Loop |
| T | 110 | East Rhodo Loop |
| U | 65 | Species Valley |
| V | 650 | Engelbert Nature Trail |
| W | 90 | Connecting Track 1 |
| X | 50 | Connecting Track 2 |
| Y | 75 | Griffiths Walk |
| Z | 90 | Mountain Devil Walk |

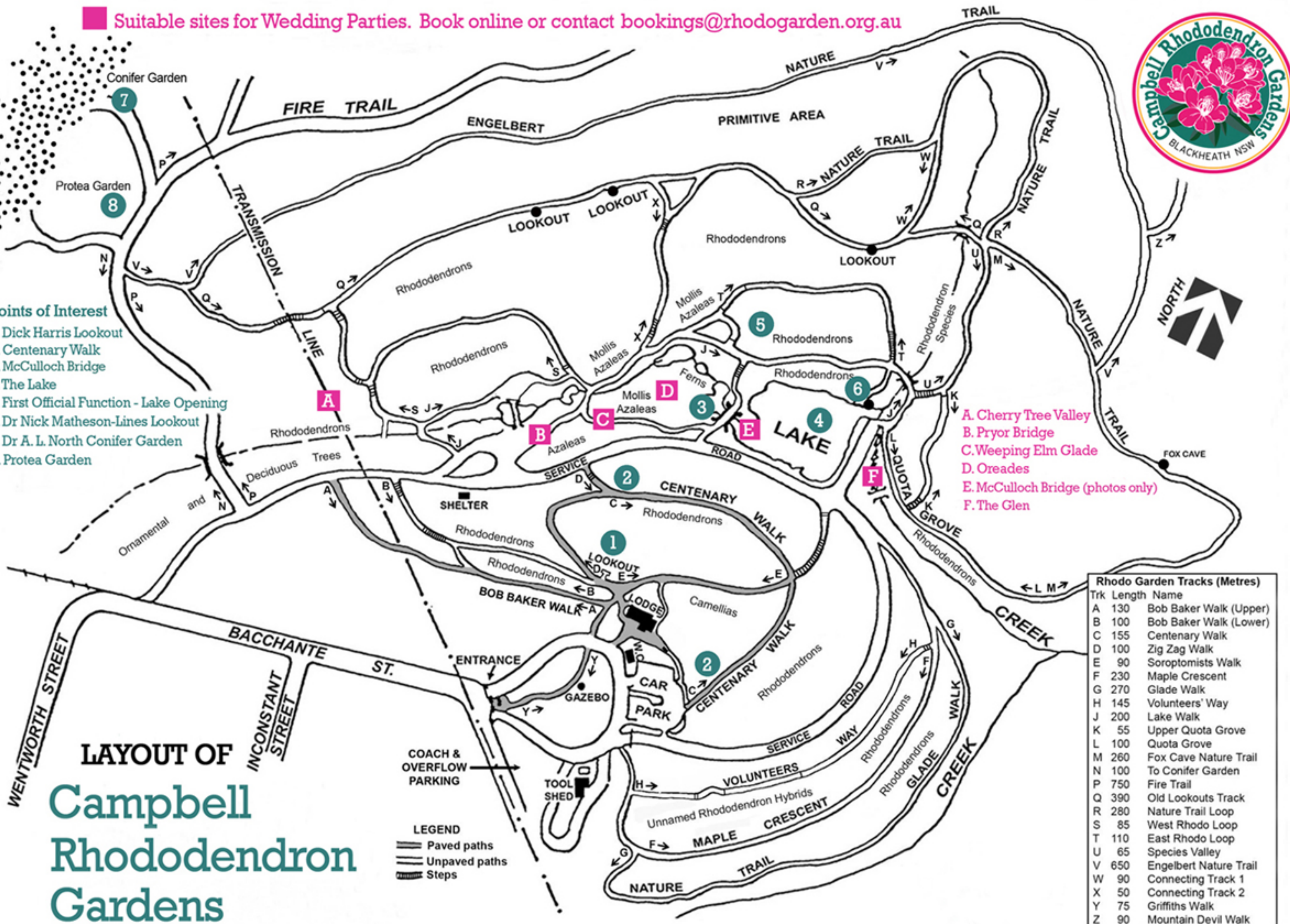

LAYOUT OF Campbell Rhododendron Gardens